

A1905/80 Waterloo Road Macquarie Park NSW

1 🏠 1 🚗

Sometimes, feeling at one with nature is all we need to feel at home. Park One is a development that aims to bring real, authentic and abundant natural elements into city living.

Located in the true heart of Macquarie Park, this collection of premier parkside residences overlooks the splendour of Sydneys Lane Cove National Park and aims to bring real, authentic and abundant natural elements into city living.

From the buzzing energy of the ground floor to the quiet refinement of the rooftop dining terrace, every element works in harmony with an organic sense of contemporary design.

Designed by DKO Architecture and TURNER, Park Ones cohesive exterior is soft and evocative in its composition

Price : Contact Agent for Inspection
View : <https://www.legendproperty.com.au/sale/nsw/north-hern-suburbs/macquarie-park/residential/apartment/7633054>



Xin (Chris) Li
0428917888



Xudong (Thomas) Zhang
0405 274 048

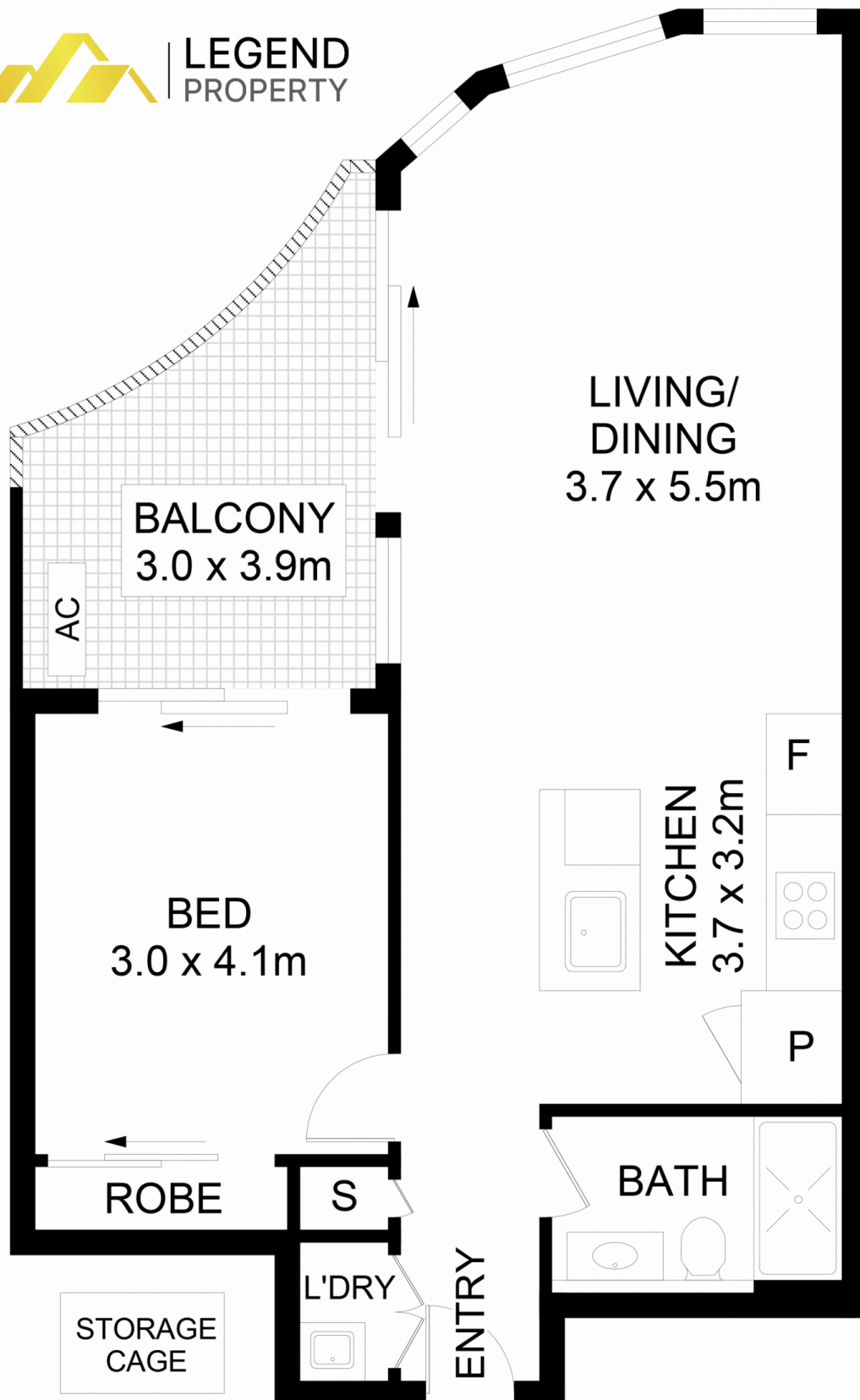

1905A/80 Waterloo Road, Macquarie Park

DISCLAIMER: No liability for the accuracy of details contained within our floor plans. All plans are drawn and also checked to the best of our ability, however information contained in our floor plans such as area calculations are approximate, and have not been surveyed or drawn to scale. Our floor plans are for representational purposes only and should be used as such. Do not attempt to refer to our floor plans for structural or detailed information.