



111/268-270 Liverpool Road Ashfield NSW

1  1  1 

This stylish apartment will impress you with its generous size and convenient location in the heart of Ashfield. Designed by award-winning architect "Marchese Partners", the Lumina Residence presents immaculately designed interiors and its rooftop entertainment area offer a comfortable and contemporary living for home-owners no matter whether you are growing your family or downsizing to a convenient and robust hub in Ashfield.

Features:

- Open-plan living area with oak timber floorboards
- High-quality stone kitchen benchtop, gas cooking and range hood
- Large bedroom with built-in wardrobe
- Spacious study room with versatility to be converted as a guest bedroom
- Sun-trenched winter garden

View : <https://www.legendproperty.com.au/sale/nsw/inne-r-west/ashfield/residential/apartment/7937082>



Xudong (Thomas) Zhang
0405 274 048



111/268-270 LIVERPOOL ROAD, ASHFIELD

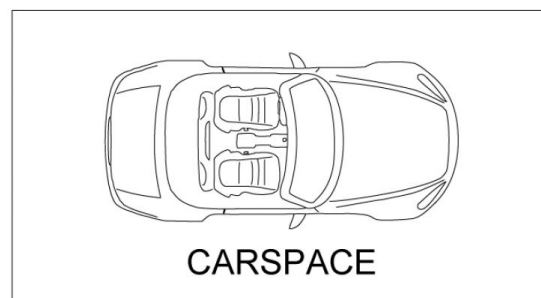
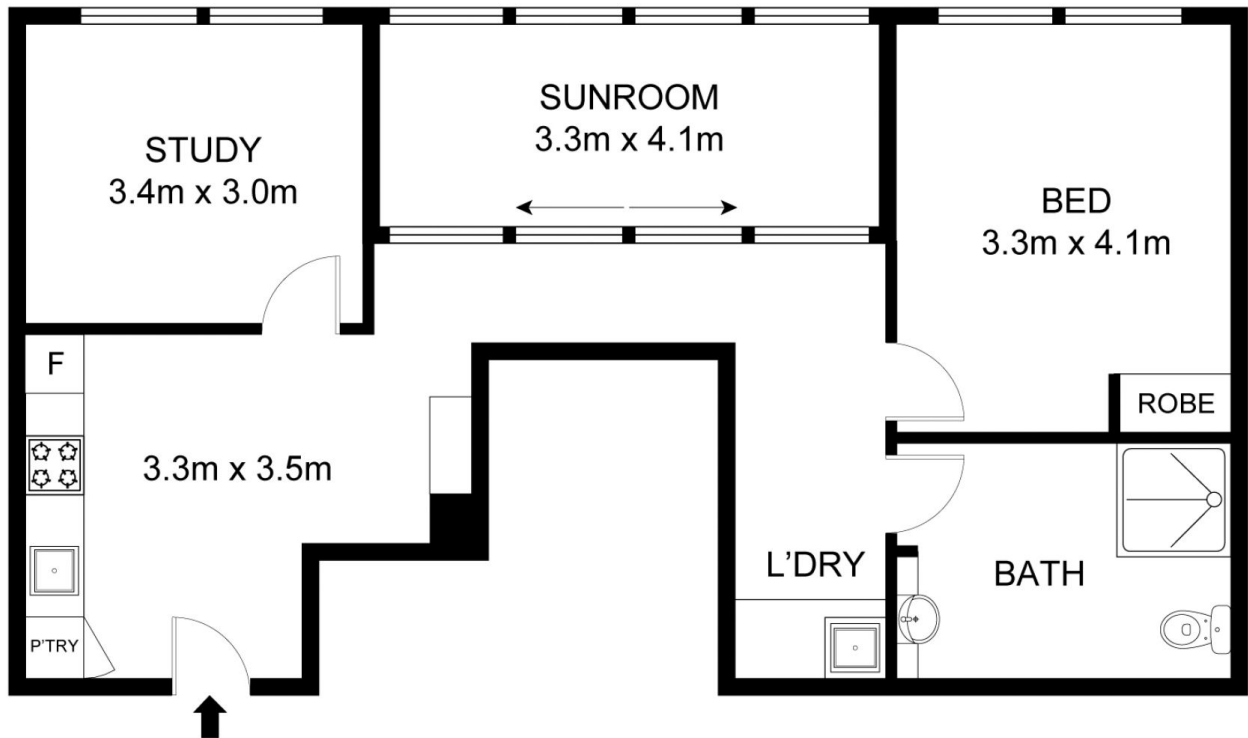

Int: 56 m²
Ext: 10m²
Total: 66 m²

THE ABOVE PLAN IS REPRESENTATION ONLY. ALL DIMENSIONS ARE APPROXIMATE SHOULD BE CHECKED ON SITE.
NO RESPONSIBILITY IS TAKEN FOR ERROR, OMISSION OR MISSTATEMENT.