





Level 34/12 Phillip Street Parramatta NSW

2  2  1 

Thoughtfully positioned on a site rich in story and history, The Lennox proudly stands tall over the Parramatta cityscape, representing a timeless and distinctive symbol while offering a truly unique and memorable living experience. Close proximity to world-class dining precincts, transport-rich hubs, endless walks and recreational activities living at The Lennox means having all your essentials right on your doorstep.

Building Size : 100 sqm
Land Size : 100 sqm
View : <https://www.legendproperty.com.au/lease/nsw/parramatta/parramatta/residential/apartment/7986604>

- Superb riverfront location:
- Metres from Church 'Eat' Street restaurants and cafes
- A short walk to Westfield Parramatta
- Short walk to Parramatta train station and ferry wharf
- Short walk to recently announced light rail station
- State-of-the-art automated car park system
- 20m swimming pool
- Gym and outdoor terrace



Gary Cheung
0415087287

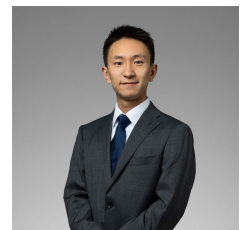

Michael Yu
0422 802 587

THE LENNOX

RIVERSIDE PARRAMATTA



Disclaimer: This document is prepared for the purpose of providing an impression of The Lennox, and is not intended for any other purpose. All details, images and statements are based on the information of, and information available to, Prime Parramatta Development Pty Ltd and its related entities, (together, Aoyuan International) as at the time of publication August 2020 and may change due to future circumstances. This document is not legally binding on Aoyuan International. Aoyuan International does not give any warranty in relation to any information contained in this document. Aoyuan International does not accept any liability for loss or damage arising as a result of any reliance on this document or its contents.



The Residences

2 BEDROOM 2 BATH

3408

INTERNAL AREA:	86 m ²
EXTERNAL AREA:	14 m ²
TOTAL AREA:	100 m ²

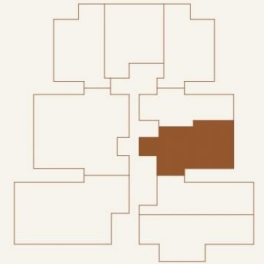

THELENNOXPARRAMATTA.COM.AU