



5608/93 Liverpool Street Sydney NSW

3  2  1 

Located on the 56th floor of the prestigious World Tower at 93 Liverpool Street, Sydney NSW 2000, this luxurious three-bedroom apartment offers an unparalleled living experience in the heart of Sydney's Central Business District. The residence boasts breathtaking panoramic views encompassing the city skyline, Darling Harbour, and extending towards the Blue Mountains.

View : <https://www.legendproperty.com.au/lease/nsw/sydney-city/sydney/residential/apartment/8270171>

Key Features:

- Panoramic Views: Floor-to-ceiling windows in the living area and both bedrooms provide uninterrupted vistas of Sydney's iconic landmarks, including regular views of Darling Harbour's fireworks displays.
- Open-Plan Living: The spacious, light-filled living and dining areas seamlessly connect to a winter garden, creating an ideal space for relaxation and entertainment.
- Modern Kitchen: Equipped with sleek stone benchtops

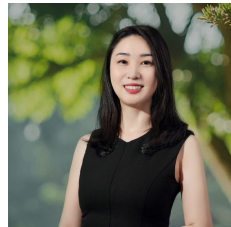

Min (Lily) Chang
0405 323 411

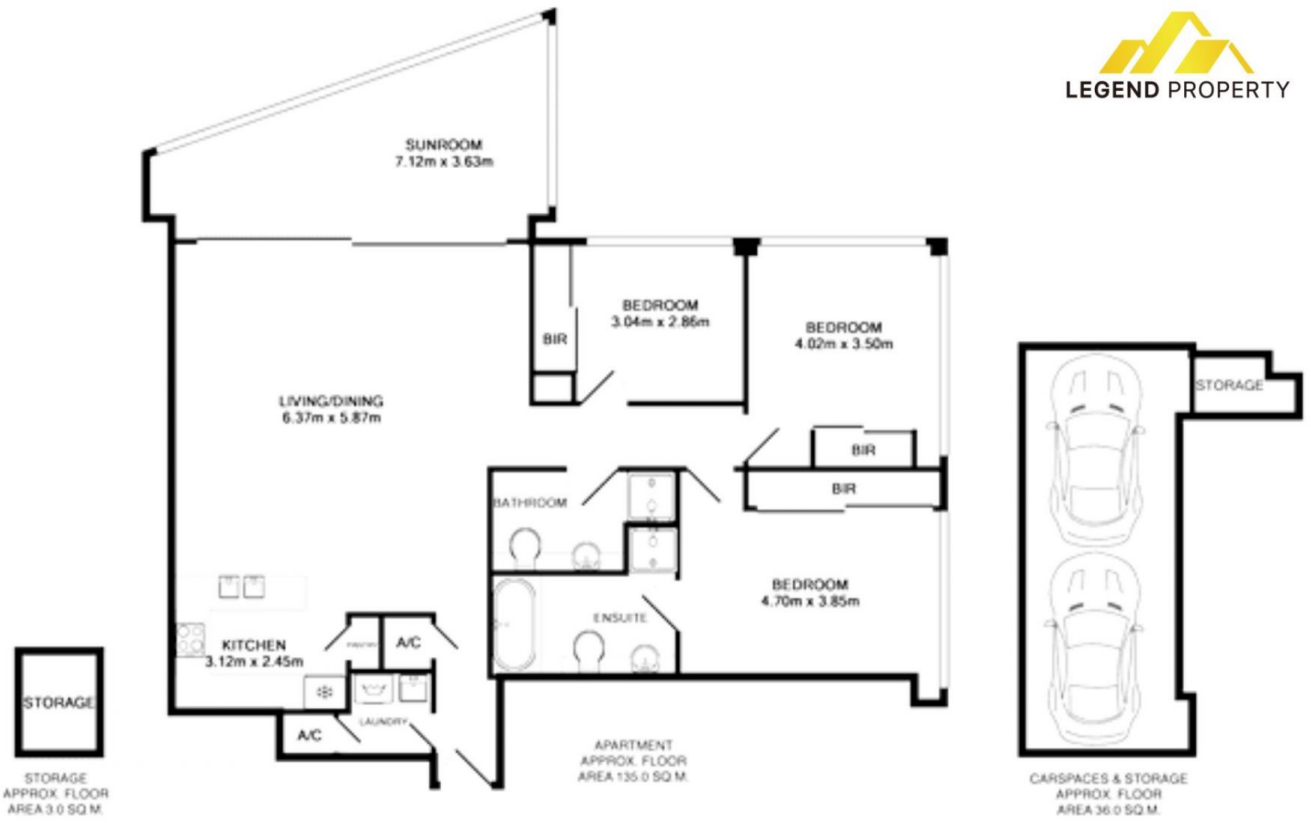

TOTAL APPROX. FLOOR AREA 174.0 SQ M. (1873 SQ FT.)
 Measurements are approximate. North Scale. For illustrative purposes only.
 Produced by Open2View.com.au