



3/1231 Victoria Road West Ryde NSW

2  1  1 

Bus stop at your door step and buses come very often to West Ryde train station by 7 minute ride.

The ultra-convenience of a 24 hour is close by , BP and McDonalds are just next door and KFC across the road!

It features:

- Bus stop on your doorstep and train station down the road
- Warm in Winter and cool in Summer
- Main bedroom has double glazed windows
- Both bedrooms with built-in wardrobes
- Polished floorboards throughout
- Good size kitchen with electric stove/oven, and window for ventilation
- 3 min drive to West Ryde shops (Coles & Woolworths) or Eastwood
- Next door to 24 hour BP, KFC and McDonalds
- Its very closed to Ermington Public School or Marsden High School

View : <https://www.legendproperty.com.au/lease/nsw/northern-suburbs/west-ryde/residential/apartment/8272908>



Yun-ning(Jenny) Chang
0420842112



Xin (Chris) Li
0428917888

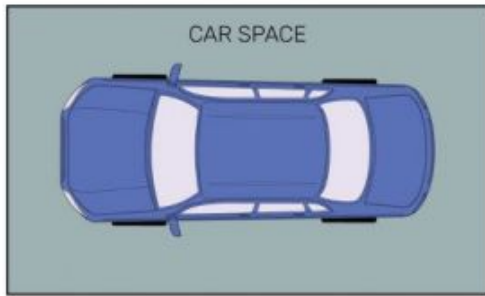
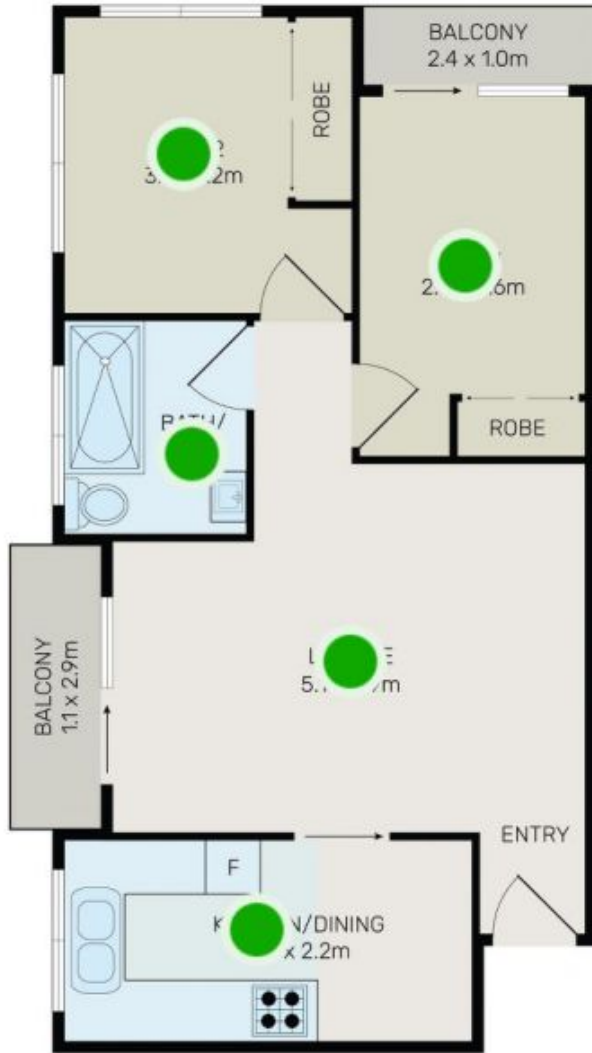

All information contained herein is gathered from all sources we believe to be reliable. However we cannot guarantee its accuracy and interested parties should rely on their own enquiries.

